

GEEPHON



7/24 Digital Signage 3500nit BAB Series

The Window Facing All-in-one BAB series with ultra high brightness, excellent readability, wonderful color expression, and local dimming technology, smart heat dissipation, multiple audio outputs, and cloud monitoring system, enable shop owners to display their Ads perfectly in semi-outdoor space influenced easily by the temperature and weather.

BAB4922A-AC-35



• Optimal Visual Clarity

- High-performance image processor.
- Delivers true color expression and high resolution.
- Offers adjustable picture quality and white balance.



• Quiet Cooling System

- Incorporates a high-flux low-noise fan and intelligent algorithms.
- Utilizes sensor data to optimize heat dissipation while minimizing noise levels.
- Specially engineered for noise-free operation.



• Outdoor Optimized High-Bright Display

- Achieves 3500 cd/m² for exceptional brightness.
- Ensures excellent visibility in direct sunlight
- Includes a smart light sensor for optimal brightness adjustment.



• Polarized Sunglasses Compatible



• Green Technology

- Features ultra-low power consumption.
- Achieves energy savings of up to 45%.



• OTA Firmware Update

- Enables remote firmware and application updates.
- Designed for seamless upgrades.



• Enhanced Component Design

- Lightweight design for easy handling.
- Constructed with high-strength aluminum alloy for durability.
- Modular components facilitate maintenance and replacement.



• GPlay Convenient U disk

- Simply insert the U disk for automatic content copying and playback on the device upon booting



• Local Dimming Innovation

- Implements LDM with an extensive number of zones.
- Achieves an ultra-high contrast ratio up to 350,000:1.



• Extended Product Warranty

- Engineered for long-term durability.
- Guarantees reliable 24/7 operation.
- Comprehensive warranty ensures customer satisfaction and confidence.



• Fail Over Support



• IPS Panel



• CMS / Remote Management Support (optional)

- Cloud-based remote management (CetusMSC) and CMS platform (GalaxyASC) support.
- Real-time monitoring of display status, parameters adjustment, and content distribution.
- Remote control via PC and Smart phone.



• Landscape/Portrait Compatible

- Portrait and landscape display orientations.



• Open API & SDK Support and RS232 Compatible

Specification

Hardware Specification

Panel	IPS
Display Size	49 inch
Protection Glass	N/A
Protection Level	IP 5X (Front Panel)
Front Color	Black
Shell	Aluminum
Set Dimension (L*W*D)	1096.18 x 626.42 x 56.85mm
Bezel Width Width(mm)	10mm
Active Display Area (H*V)	1073.78 x 604mm
Resolution	1920 x 1080
Type	MiniLED BLU
Brightness(Typ.)	3500 cd/m ²
Contrast Ratio(Typ.)	350000:1
Viewing Angle(H/V)	178°(H) x 178°(V)(CR≥10)
Display Colors	16.7M
Color Gamut	72%
Response Time	8ms (Typ)
Operation Hour	24/7
Panel Orientation	Landscape/ Portrait
Smart Solution	PTC.DT1AHE-LAB
Connectivity	USB2.0*2, HDMI In*2, HDMI Out*1, Ethernet(RJ45)*2, RS232(RJ45)*1, Line Out*1, Sensor*1, IR In*1
Power	Input Supply: 100-240V AC , 50/60Hz
Power Consumption	290W
Speaker	5W/8Ω *2
IR	External connection
Touch	N/A
Camera	N/A
Installation	Wall mount
VESA Mount	300 x 250mm
Package(W*H*D)	1224 x 759 x 180mm
Weight (kg)	N.W: 23.6 kg G.W: 26.7kg
Operating Temperature	0°C ~ +40°C(Direct Sunlight) 0°C ~ +50°C(w/o Direct Sunlight)
Storage	-10°C ~ +60°C

System Specification

CPU	ARM Quad Core Cortex-A53 1.5G
GPU	ARM Mali-G52 2EE MC1
Operating System	Android 9
Screen Health	Smart Backlight Control - Yes
	Smart Temperature Control - Yes
	Smart Fans Control - No
	Smart Monitoring System Cloud - Yes/CetusMSC
Remote Management	Overheating Protection - Yes
Cloud Advertising	Optional
Distribution System	
Cloud Splice System	Optional
Memory	DDR 2G
Storage	EMMC 16GB
Ethernet	Ethernet (RJ45)
	WiFi 802.11b/g/n 4G LTE(FDD/TDD) (Optional)
Panel Image Rotation	0/90/180/270/360 Angle Rotation
Video Decoder	MPEG-1/2/4, H.264, HEVC, VP8, VP9, AVS+, AVS2, AV1
Audio Decoder	MPEG-1, MPEG-2(layer I/II) MP3, AAC-LC, HE-AAC
Picture Decoding	JPG, JPEG, PNG, BMP

What's in the box

Power Cable	x 1 Power cord (based on region)
Remote Controller	x 1
RS232 Adaptor	x 1
Wifi Antenna	x 1
IR Receiver	x 1
Lifting Ring	x 2
Fillier Pad	x 2
Spring Pad	x 2

Warranty

Warranty	Three year or by contract
----------	---------------------------

Dimensions

Unit: mm

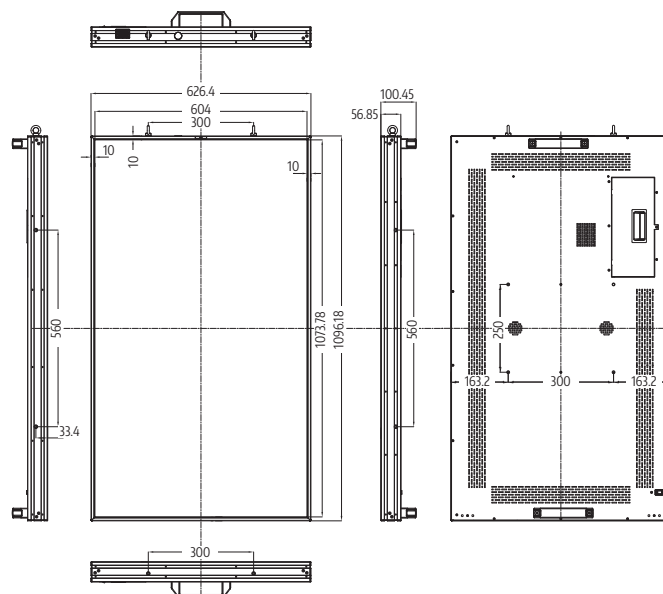

* Compatibility may differ by equipment.
* Software compatibility may change over time. Please contact your regional sales representative for details.
* Specifications are subject to change without notice, so please contact sales team to verify before ordering